

CONSTRUCTION NOTES

1. CONTRACTOR SHALL CHECK AND VERIFY ALL DIMENSIONS AND CONDITIONS AT THE BUILDING SITE BEFORE COMMENCING WORK.
2. ALL EGRESS DOORS SHALL COMPLY WITH PENNSYLVANIA DEPARTMENT OF LABOR AND INDUSTRY EGRESS REQUIREMENTS AND SHALL BE EQUIPPED WITH AUTOMATIC CLOSERS, POSITIVE LATCHING, AND PANIC DEVICES WHERE REQUIRED.
3. FIRE EXTINGUISHERS SHALL BE INSTALLED IN ACCORDANCE WITH PENNSYLVANIA DEPARTMENT OF LABOR AND INDUSTRY FIRE AND PANIC REGULATIONS, PARAGRAPH 55.71.
4. DESIGNATED HANDICAPPED TOILET ROOMS SHALL COMPLY WITH PENNSYLVANIA ACT 235 AND AMENDED ACT 216 IN ADDITION TO ANSI A117.1 - 1986.
5. ALUMINUM METAL STUD PARTITIONS TO BE TYPE CHOICE OF P.L.E. TUBES.
6. SOLID STELLATIONAL INSULATION AT PARTITIONS TO EXTEND 1'-0" ABOVE CEILING HGT. OR TO TOP OF DRYWALL. (KEY)
7. (C) SURFACE MOUNTED FIRE EXTINGUISHERS.

FINISHES:
 X-RAY ROOM -
 FLOOR - SHEET VINYL
 BASE - RUBBER EXISTING IS INTEGRAL (CONTRACTORS OPTION)
 WALLS - PAINTED GYP BD
 CEILING - ACT

NOTE: AT NEW WORK OF DEMOLITION, PATCH EXISTING FINISHES TO MATCH EXISTING.

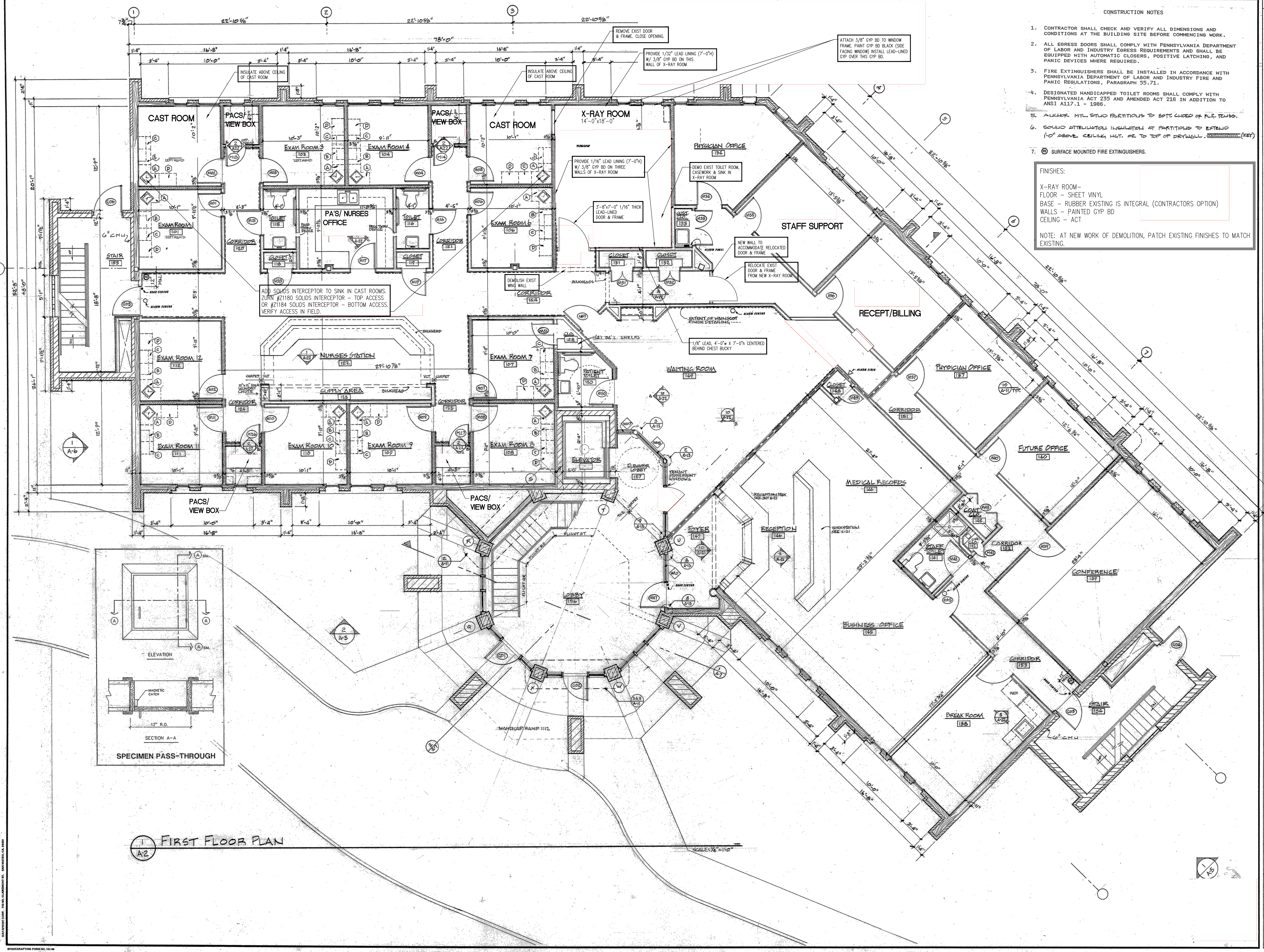

GATEWAY CENTRE
 601 HAWTHORNE DRIVE
 HOLLIDAYSBURG, PA.

RALPH J. ALBARANO & SONS, INC.
 BUILDER
 1873 OLD RTE. 22 DUNC. INSVILLE, PA. 16835